



The power behind competitiveness

Delta M80U

Grid-tied, 3-phase and transformerless PV Inverter



Product Features

- Two stage topology with wide input operation range, 200 to 1000 Vdc
- Allow 0-90° mounted installation
- Dual MPP tracker inputs
- Superior efficiency performance, 98.8% peak & 98.5% CEC
- Capable of landing up to 18 strings via fused inputs
- NEMA 4X outdoor rated enclosure
- Ergonomics grip design
- Integral DC Arc fault detector
- Integral AC & DC disconnects
- Integral type 2 SPDs at AC & DC terminals
- Operating temp. range -25°C to +60°C
- String monitoring



Delta M80U

IP68 Swappable Fan Kit

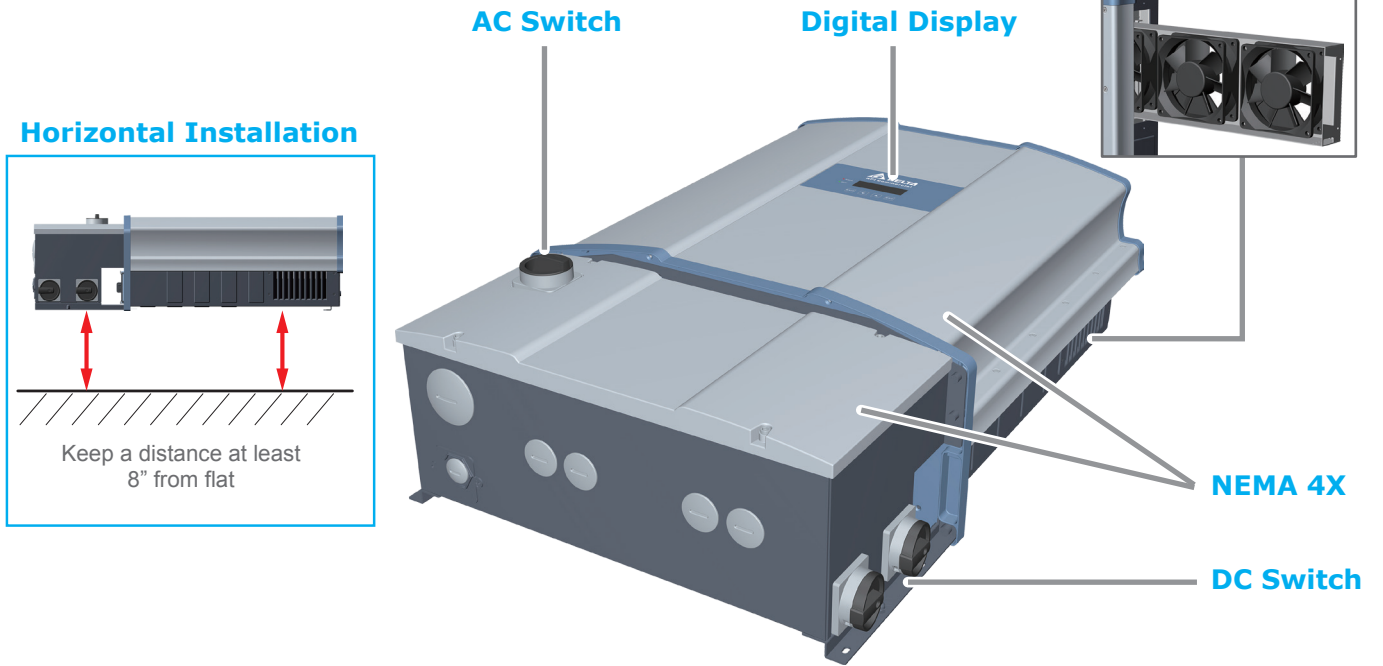

Wiring Box Configurations

M80U_120

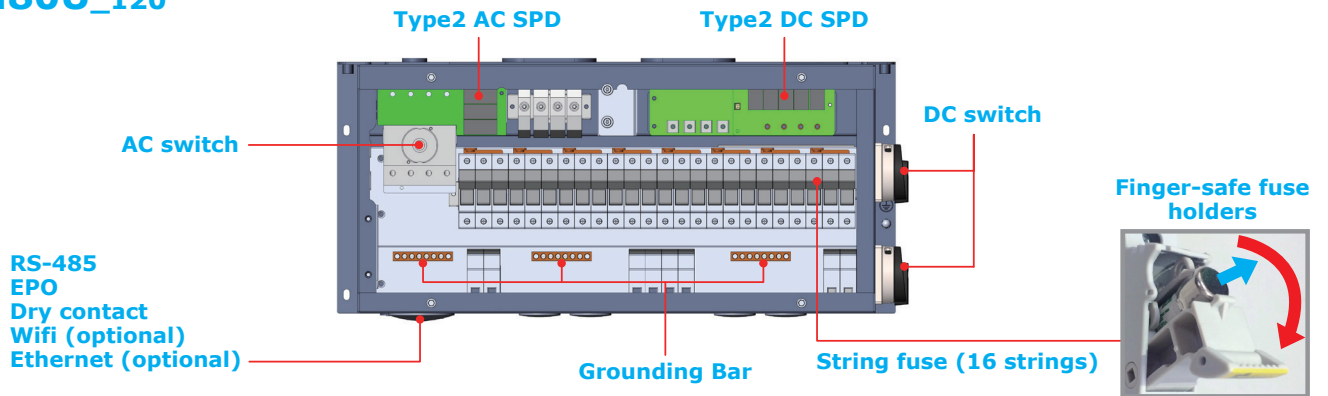

M80U_121

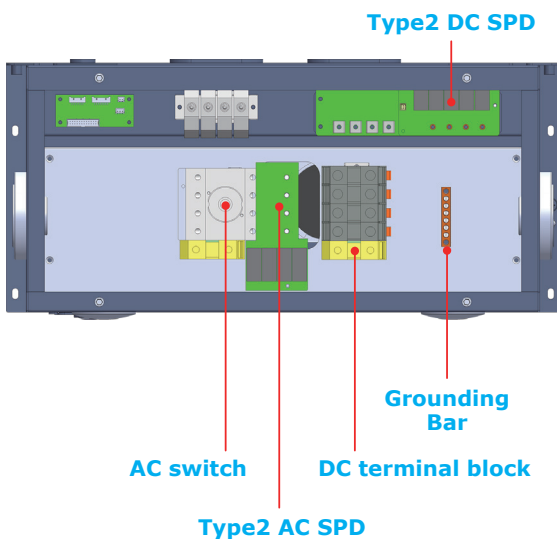

M80U_122

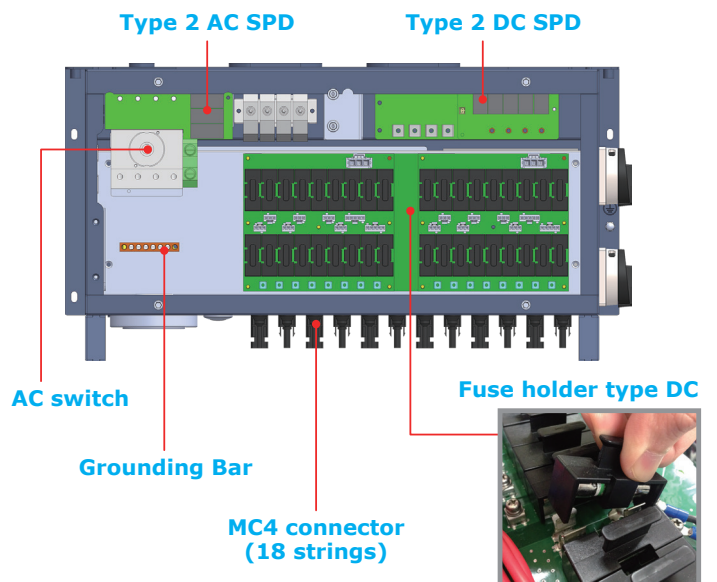

Outstanding performance

M80U have excellent efficiency performance, peak 98.8% and CEC 98.5%.



Benefits with M80U

Multi-application:

Designed for commercial, industrial and utility applications.

All-in-one Design:

String fuses, surge protection devices, DC switches and arc fault detection circuit are integrated into the design.

Saving on Space Cost:

Horizontal mounting allows under array location without need for additional housing.

2 MPP Trackers:

The use of two MPP trackers provides greater flexibility in PV array configuration leading to a maximized yield.

Easy Installation:

Ergonomic grip design provides easy installation or removal by the installer. For additional flexibility, eye bolts are provided to allow for lifting using crane.

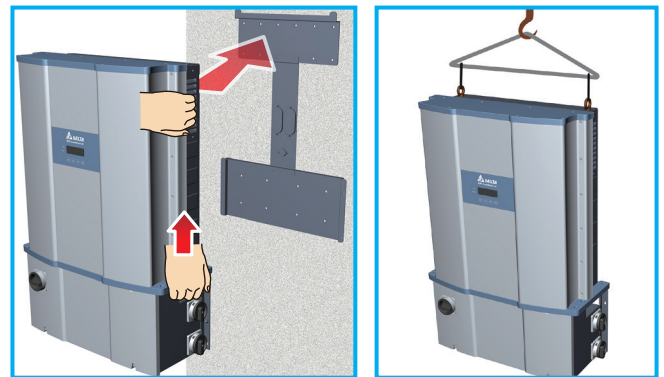

String monitoring function:

The string monitoring function can precisely record real-time current value up to 18 strings via RS-485 interface.

IDC1 (A)	IDC1 (A)	IDC2 (A)	IDC2 (A)
1: 1.6	7: 1.6	1: 1.4	7: 1.0
4: 1.6	8: 1.6	4: 1.6	8: 1.6
2: 1.6	9: 1.6	2: 1.6	9: 1.6
5: 1.7		3: 1.5	
3: 1.6		6: 1.6	

Delta Commercial Series

Model	M80U_120	M80U_121	M80U_122
DC Input			
Recommended PV power	106kW		
Max. input voltage	1100V		
Operating voltage range	200-1000V		
Start voltage	>250V		
MPP voltage, rated power	600~800V		
Rated voltage	710V		
MPP tracker	2		
Max. operating current / Each MPPT	140A / 70A		
Max. allowable array Isc	100A/MPPT, 200A total		
Connection type	16 pairs of 8~14 AWG fuse holder (Cu/Al wire, 90°C rated)	1~3/0 AWG terminal block (Cu/Al wire, 120°C rated)	18 pairs of MC4 connector (90°C rated)
Type 2 SPD	O	O	O
15A string fuses	O	X	O
DC Switch	O	X	O
String monitoring	X	X	O
AC Output			
Rated output power	80kW		
Max. output power	83kW		
Max. output current	100A		
Rated voltage	3Ph 480V Δ	3Ph 480V Y or Δ	
Operating voltage range	±10%		
Operating frequency range	50/60Hz ±5Hz		
Power factor	Unity at rated power, 0.8 ind ~ 0.8 cap adjustable		
Protection	Type 2 SPD		
THD	<3%		
Connection type	1-2/0 AWG terminal block (Cu/Al wire, 120°C rated)		
Night time consumption	<3W		
Efficiency			
Peak efficiency	98.8%		
CEC efficiency	98.5%		
Information			
Communication port	RS-485		
Display	20 x 4 LCD		
Regulation			
	UL1741, UL1998, UL 1699B, IEEE1547, IEEE1547.1 CSA C22.2 EN61000-6-2, EN61000-6-3, IEC 62109-1/-2		
General Data			
Smart inverter functionality	Voltage/Frequency Ride through, Volt/Var, Volt/Watt, Power curtailment, Frequency/Watt		
Operating temp. range	-13°~140°F (-25°~60°C)		
Protection level	NEMA 4X		
Operating elevation	<9800ft (<3000m)		
Cooling	Forced air cooling plus Smart Fan control		
Dimension (in)	24.2 x 35.4 x 10.8		24.2 x 37.4 x 10.8
Weight (lb)	W/ Wiring box	180.6	171.8
	W/O Wiring box		149.9

- All specifications are subject to change without prior notice.

DELTA ELECTRONICS, INC.

39 Section 2 Huandong Road,
Shanhua Township,
Tainan County 74144, Taiwan,R.O.C.
TEL 886-6-5056565
FAX 886-6-5051919
<http://www.deltaww.com>

